



# ULTRAFAST™

The Ultimate in High Speed Doors

## ► SPEED

UltraFast™ opens at up to 60 inches per second.

## ► CONTROLS

Albany's UltraSmart™ Controller is people friendly and extremely intuitive. Control box includes an integrated rotary disconnect standard.

## ► VISIBILITY

UltraFast™ offers full width vision standard

## ► PANEL MATERIAL

Two ply monofilament standard with three ply monofilament and vinyl panels optional. Blue and yellow standard.

## ► MAINTENANCE

The self-repairing UltraFast™ is designed to be low maintenance and cycle hundreds of thousands of times.

## ► BACSEAL™ WEATHER SEAL

The UltraFast™ seal is unmatched. The top header and side frames are sealed tight.

## ► WIRELESS SAFETY SYSTEM

Eliminate coil cords with Albany's patent pending wireless safety system.

Albany Door Systems' self-repairing UltraFast™ high speed door is a work-horse. It was designed specifically for high traffic, heavy duty, industrial and commercial applications. The door can be applied in either interior or exterior applications where moderate wind and/or negative pressure are a problem. When fork-truck traffic is high, maintenance is a concern and safety concerns are at a premium, UltraFast™ is the solution.



# ULTRAFAST™

Albany's self-repairing UltraFast™ high speed industrial doors are tough, built to last, and engineered to cycle hundreds of thousands of times.

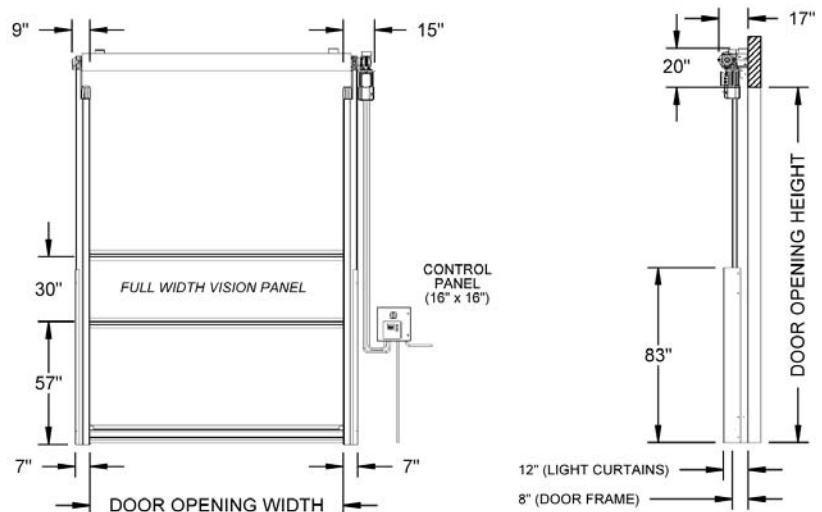

## BacFlap™ Auto-Reset System

When impacted the door panel will automatically reset itself. BacFlaps™ insure against panel tearing.



## BacLight™ Safety System (Optional)

Albany's exclusive safety light barrier projects a curtain of light approximately six feet tall across both sides of the door panel to prevent injuries.



## UltraSmart™ Controller

UltraSmart™ walks you through problems on the control screen. Modular components minimize cost and improve reliability.

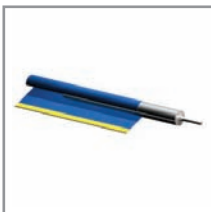

## Patent Pending Modular Design

The Albany patent pending extrusion design allows for easy maintenance and repair in the field.



## BacOut™ Safety System (Optional)

Counter-Balance design allows the door to be manually raised in the event of a power failure. No manual cranks in the event of an emergency. Availability depends on door size.

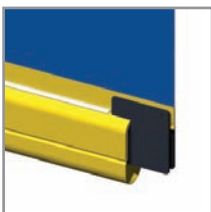

## BacTrack™ Soft Bottom Bar (Optional)

Fully padded safety bottom bar that automatically resets after impact. Self-repairing.



## BacSeal™ Weather Seal

Double seal on the back spreader bar and double seal on the front extrusions. When the door is down, the panel is sealed.

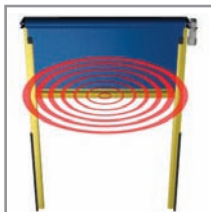

## Wireless Safety System

Cut your cord with Albany's patent pending Wireless Safety System and eliminate costly repairs and downtime associated with coil cords.